

WEIGHT BRACKET KIT

Model No. 45-04371



SAFETY RULES

Remember, any power equipment can cause injury if operated improperly or if the user does not understand how to operate the equipment. Exercise caution at all times when using power equipment.



LOOK FOR THIS SYMBOL TO POINT OUT IMPORTANT SAFETY PRECAUTIONS. IT MEANS — ATTENTION! BECOME ALERT! YOUR SAFETY IS INVOLVED.



VEHICLE BRAKING AND STABILITY MAY BE AFFECTED WITH THE ADDITION OF AN ACCESSORY OR AN ATTACHMENT. BE AWARE OF CHANGING CONDITIONS ON SLOPES.

- Refer to your tractor owners manual for "Rules For Safe Operation."
- Do not use more than one 55 lb. weight with this bracket.

- Use 55 lb. weight for snow removal or tilling only.
- Weight must be removed when mower deck is installed.

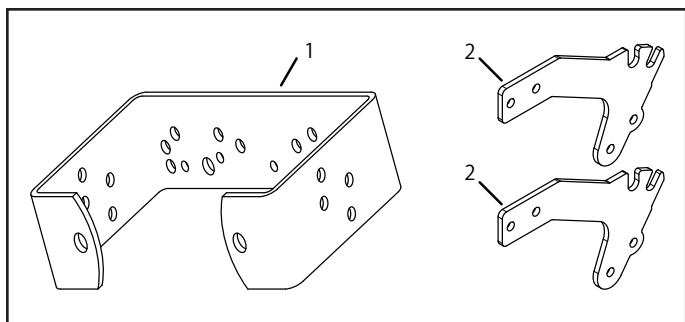

CARTON CONTENTS

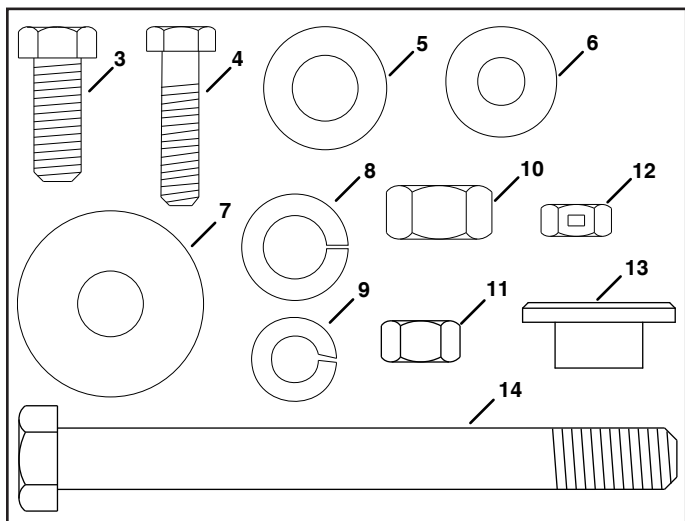

HARDWARE PACKAGE

REF	QTY	PART NO	DESCRIPTION
1	1	24215BL3	Weight Bracket
2	2	26553BL1	Weight Bracket Arm
3	6	43001	Hex Bolt, 3/8-16 x 1"
4	2	43840	Hex Bolt, 5/16-18 x 1-1/4"
5	2	R19171616	Washer, .1/2" x 1" O.D.
6	2	43081	Washer, 5/16"
7	2	R19172410	Washer, 1/2" x 1-1/2" O.D.
8	2	43353	Lock Washer, 1/2"
9	6	43003	Lock Washer, 3/8"
10	2	712-0206	Nex Nut, 1/2"-13
11	6	43015	Hex Nut, 3/8"-16
12	2	43064	Lock Nut, 5/16"-18
13	2	1657-5	Step Bushing
14	2	R74760884	Hex Bolt, 1/2-13 x 5-1/2"

LOCATE YOUR TRACTORS SERIAL NUMBER

Look under the seat of your tractor and locate the model number. For tractors with model numbers beginning with 917, proceed to page 3. For tractors with model numbers beginning with 247, proceed to page 4. For Husqvarna tractors with slanted drawbars proceed to page 5 or 6.

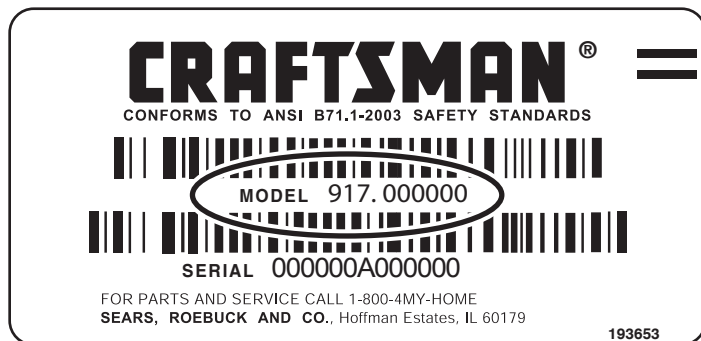

**917 MODEL TRACTORS
GO TO PAGE 3**

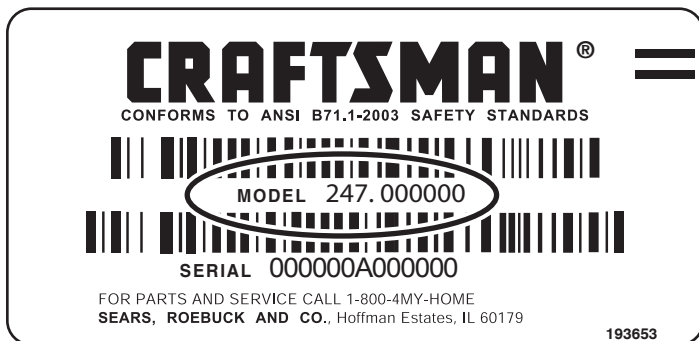

**247 MODEL TRACTORS
GO TO PAGE 4**

ASSEMBLY INSTRUCTIONS FOR MODEL 917 TRACTORS

IF YOU HAVE THIS STYLE DRAWBAR:

1. Assemble two 1.5" O.D. washers (7) onto two 3/8"-16 x 1" hex bolts (3). Insert bolts through drawbar and assemble weight bracket (1) onto bolts. Fasten securely with two 3/8" lock washers (9) and two 3/8"-16 hex nuts (11). See figure 1.
2. Assemble wheel weight to weight bracket (1) using two 1/2" x 5-1/2" hex bolts (14), 1" O.D. washers (5), 1/2" lock washers (8) and 1/2"-13 hex nuts (10). Tighten securely. See figure 1.

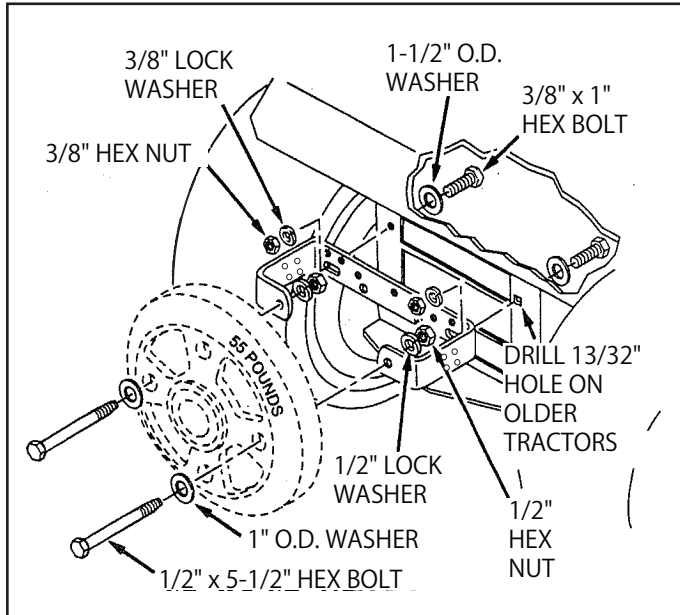

FIGURE 1

Use figure 3A for most tractors with this style drawbar. Use figure 3B if the weight bracket interferes with the gas tank.

5. Assemble weight bracket (1) to weight bracket arms (2) using four 3/8-16 x 1" hex bolts (3), 3/8" lock washers (9) and 3/8"-16 hex nuts (11). See figure 3.
6. Assemble wheel weight to weight bracket (1) using two 1/2" x 5-1/2" hex bolts (14), 1" O.D. washers (5), 1/2" lock washers (8) and 1/2"-13 hex nuts (10). Tighten securely. See figure 3.

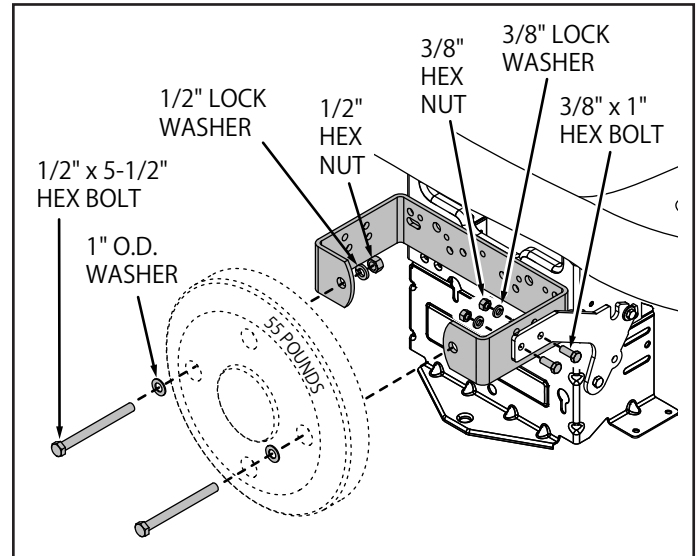

FIGURE 3A

IF YOU HAVE THIS STYLE DRAWBAR:

3. Assemble bottom of two weight bracket arms (2) to sides of drawbar using two 3/8-16 x 1" hex bolts (3), 3/8" lock washers (9) and 3/8"-16 hex nuts (11). See figure 2.
4. Assemble top of two weight bracket arms (2) to sides of drawbar using front notches in arms. Use two 5/16-18 x 1-1/4" hex bolts (4), step bushings (13), 5/16" washers (4) and 5/16" lock nuts (12). See figure 2.

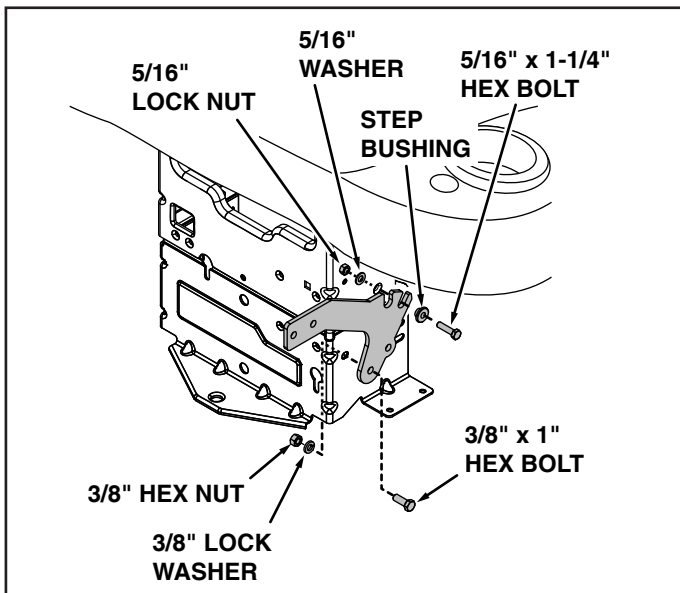

FIGURE 2

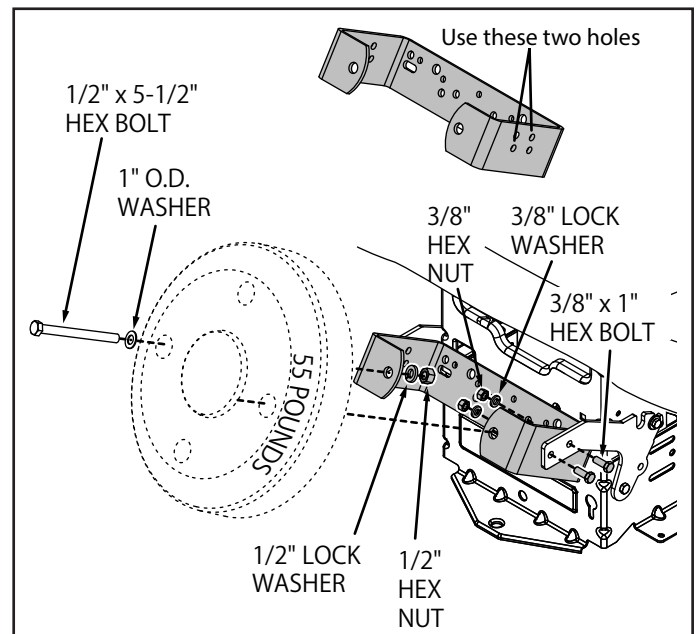

FIGURE 3B

ASSEMBLY INSTRUCTIONS FOR MODEL 247 TRACTORS

1. Place the second notch in top of weight bracket arm (2) onto shoulder bolt in side of drawbar. Secure bottom of arm to drawbar using a 3/8-16 x 1" hex bolt (3), a 3/8" lock washer (9) and a 3/8"-16 hex nut (11). Repeat on other side. See figure 4.

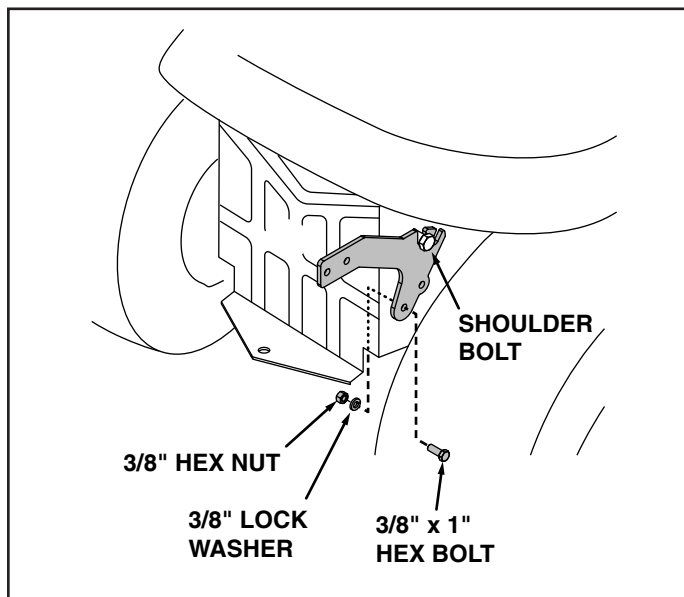

FIGURE 4

2. Assemble the weight bracket (1) to weight bracket arms (2) using four 3/8-16 x 1" hex bolts (3), 3/8" lock washers (9) and 3/8"-16 hex nuts (11). See figure 4.
3. Assemble wheel weight to weight bracket (1) using two 1/2" x 5-1/2" hex bolts (14), 1" O.D. washers (5), 1/2" lock washers (8) and 1/2"-13 hex nuts (10). Tighten securely. See figure 4.

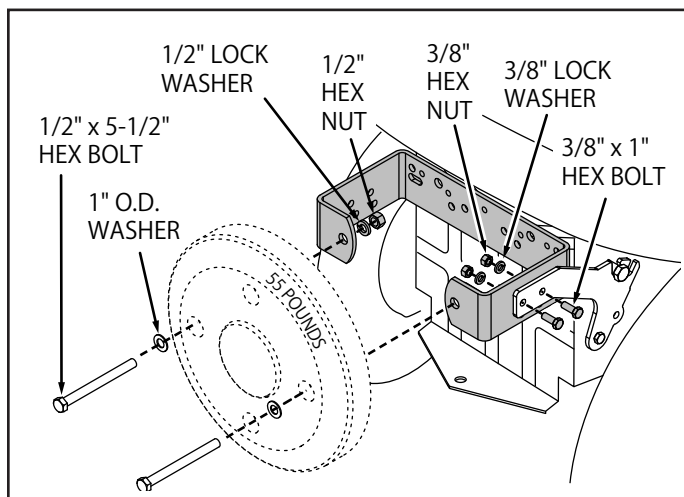

FIGURE 5

ASSEMBLY INSTRUCTIONS FOR HUSQVARNA TRACTORS WITH SLANTED DRAWBAR AND ACTUATOR BEHIND DRAWBAR

1. If your tractor has a shoulder bolt on the side of the drawbar go to step 2A and if no shoulder bolt go to step 2B.
- 2A. Place the second notch in top of weight bracket arm (2) onto shoulder bolt in side of drawbar. Secure bottom of arm to drawbar using a 3/8-16 x 1" hex bolt (3), a 3/8" lock washer (9) and a 3/8-16 hex nut (11). Repeat on other side. See figure 6.
- 2B. Secure top of weight bracket arm (2) to side of drawbar using front notch in arms. Use two 5/16-18 x 1-1/4" hex bolt (4), step bushing (13), 5/16" washer (4) and 5/16" lock nuts(12). Repeat on outhar side. See figure 6.
3. Secure bottom of arm to drawbar using a 3/8-16 x 1"

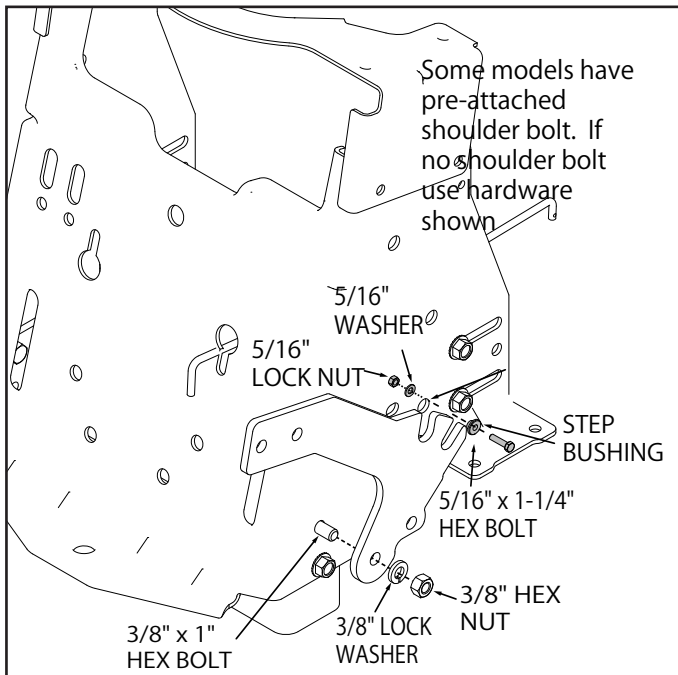

FIGURE 6

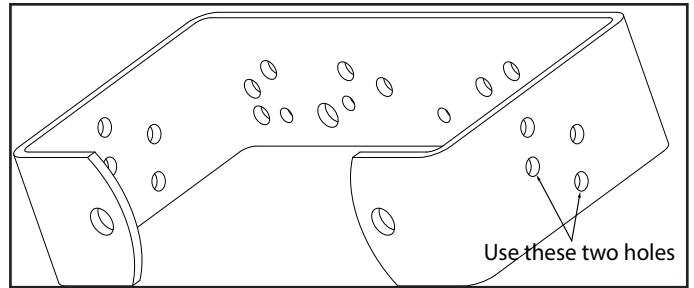

FIGURE 7

Figure 7 shows holes to use when installing the weight bracket (1). The open side of weight bracket (1) needs to face downwards.

4. Secure weight bracket (1) to weight bracket arms (2) using four 3/8"-16 x 1" hex bolts (3), 3/8" lock washers (9) and 3/8-16 hex nuts (11). See figure 8.
5. Secure wheel weight to weight bracket (1) using two 1/2" x 5-1/2" hex bolts (14), 1" O.D. washers (5), 1/2" lock washers (8) and 1/2"-13 hex nuts (10). Tighten securely. See figure 8.

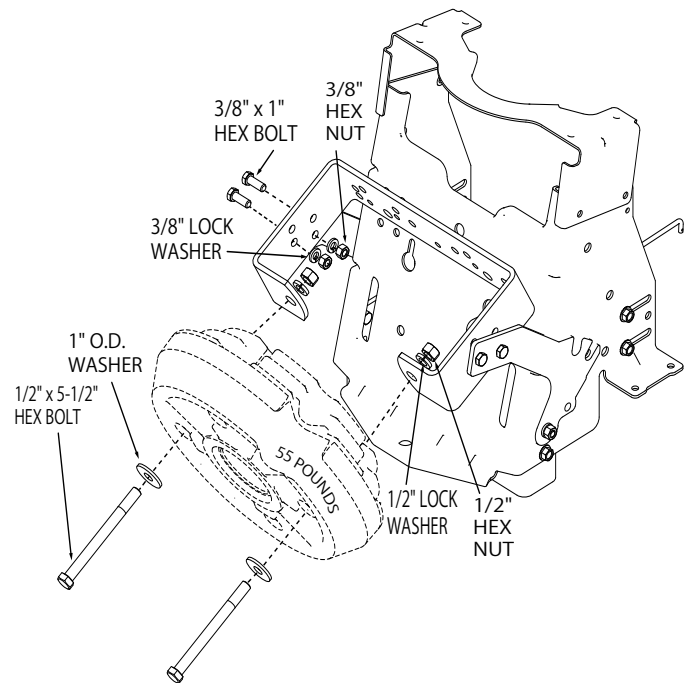

FIGURE 8

SLANTED DRAWBAR AND NO ACTUATOR BEHIND DRAWBAR

1. Assemble two 1.5" O.D. washers (7) onto two 3/8"-16 x 1" hex bolts (3). Insert bolts through drawbar and assemble weight bracket (1) onto bolts. Fasten securely with two 3/8" lock washers (9) and two 3/8"-16 hex nuts (11). See figure 9.
2. Secure wheel weight to weight bracket (1) using two 1/2" x 5-1/2" hex bolts (14), 1" O.D. washers (5), 1/2" lock washers (8) and 1/2"-13 hex nuts (10). Tighten securely. See figure 9.

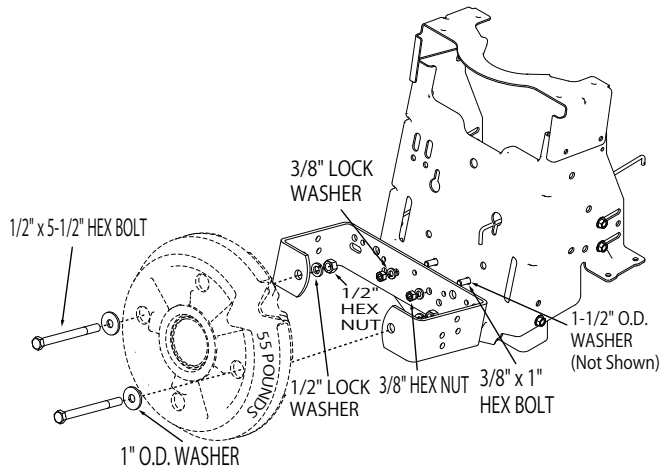

FIGURE 9

THIS PAGE INTENTIONALLY LEFT BLANK

SpeedEPart *the fastest way to purchase parts* www.speedepart.com

REPAIR PARTS
Agri-Fab, Inc.
809 South Hamilton
Sullivan, IL. 61951
217-728-8388
www.agri-fab.com

This document (or manual) is protected under the U.S. Copyright Laws and the copyright laws of foreign countries, pursuant to the Universal Copyright Convention and the Berne convention. No part of this document may be reproduced or transmitted in any form or by any means, electronic or mechanical, including photocopying or recording, or by any information storage or retrieval system, without the express written permission of Agri-Fab, Inc. Unauthorized uses and/or reproductions of this manual will subject such unauthorized user to civil and criminal penalties as provided by the United States Copyright Laws.